

# AIR COOLED, TWO STAGE MODEL E-15

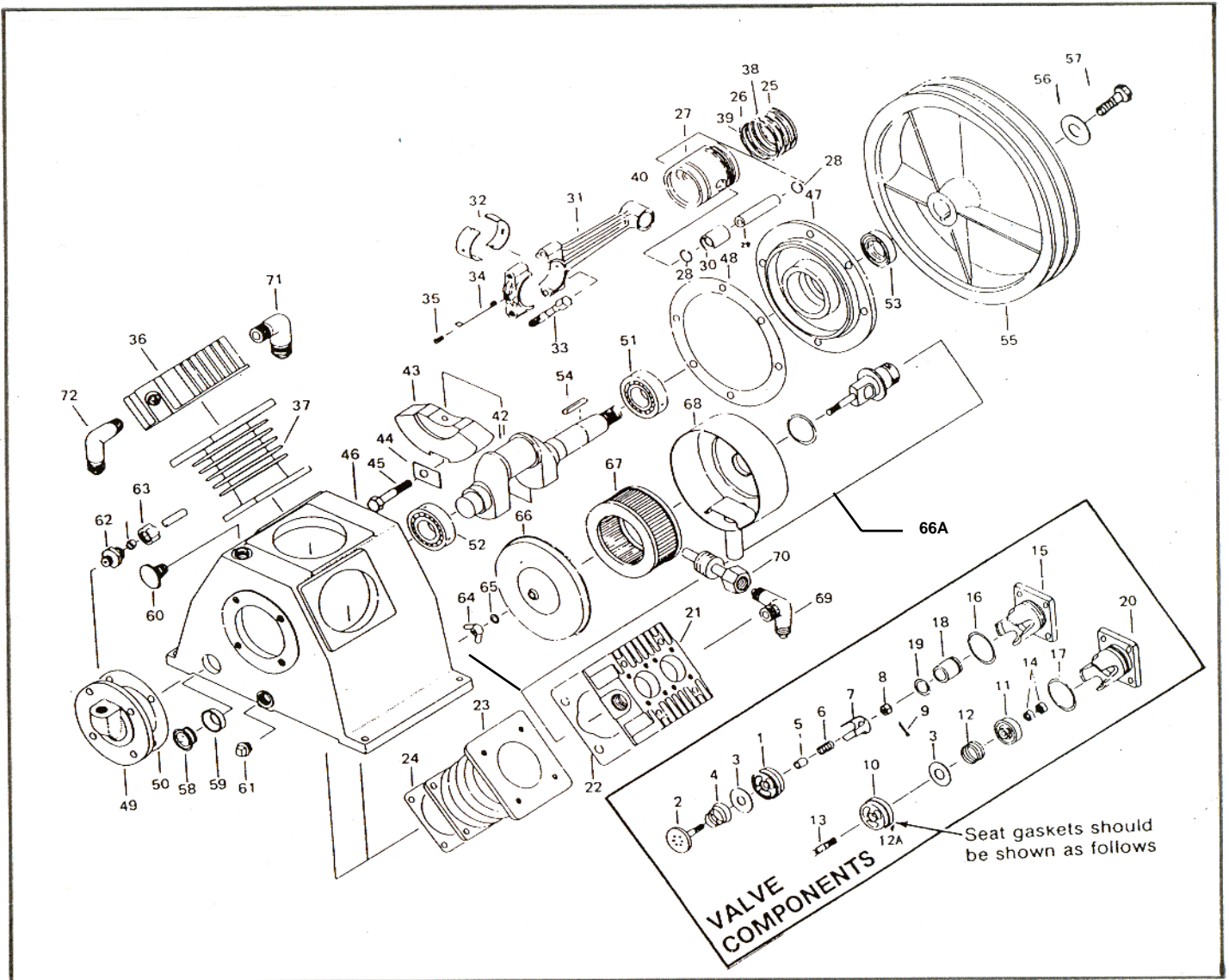

VALVE ASSEMBLIES	Description	Qty. Req.	MODEL E15
	Inlet Valve Assembly, 1 <sup>st</sup> Stage	2	70125-31000
	Inlet Valve Assembly, 2 <sup>nd</sup> Stage	1	70175-32000
	Outlet Valve Assembly, 1 <sup>st</sup> Stage	2	70125-41000
	Outlet Valve Assembly, 2 <sup>nd</sup> Stage	1	70175-42000
	Breather Assembly	1	70124-57600-4010

## MAIN PARTS LISTING FOR TWO STAGE MODEL E-15

Description	MODEL E15			
	Qty Req'd	1 <sup>st</sup> Stage	Qty Req'd	2 <sup>nd</sup> Stage
<b>VAVLES &amp; UNLOADERS</b>				
1. Inlet Valve Seat	2	70125-31010	1	70124-31010
2. Inlet Valve Receiver	2	70125-31022	1	70124-31020
3. Inlet & Outlet Valve Plate	4	70125-31030	2	70175-42030
4. Inlet Valve Spring	2	70125-31070	1	70124-31070
5. Inlet Valve Unloading Fork Guide	2	70125-31090	1	70124-31090
6. Unloading Spring	2	70125-11230	1	70124-11230
7. Inlet Valve Unloading Fork	2	70125-31080	1	70124-31080
8. Slotted Nut	2	92502-230800	1	92502-230800
9. Cotter Pin	2	93701-130220	1	93701-130220
10. Outlet Valve Seat	2	70125-41011	1	70124-41010
11. Outlet Valve Receiver	2	70125-41021	1	70175-42020
12A. Seat Gaskets	4	70125-11110	2	70124-11110

## MAIN PARTS LISTING FOR TWO STAGE MODEL E-15 (Continued)

	DESCRIPTION	MODEL E15			
		Qty Req'd	1 <sup>st</sup> Stage	Qty Req'd	2 <sup>nd</sup> Stage
VALVES & UNLOADERS	12B. Outlet Valve Spring	2	70125-41071	1	70124-41072
	13. Outlet Valve Bolt	2	70124-41810	1	70124-41810
	14. Nut (Outlet Valve)	2	92501-231000	1	92501-231000
	15. Inlet Valve Push Cover	2	70125-11151	1	70175-12150
	16. O-Ring G-65 (Inlet Valve)	2	93602-810065	1	93602-870055
	17. Viton O-Ring G-65 (Outlet Valve)	2	93602-870065	1	93602-870055
	18. Unloading Piston	2	70125-11220	1	70124-11220
	19. O-Ring P-20	2	93601-810022A	1	93601-870021
	20. Outlet Valve Push Cover	2	70125-11451	1	70175-12450
	20A. Outlet Valve Push Cover Push Pipe	1	70124-11120		
CYLINDERS	21. Cylinder Head (1 <sup>st</sup> )	2	70125-11010		
	21A. S/N A31XXXX & Later Use	2	70135-11010		
	22. Cylinder & Head Gasket	2	70125-11612	1	70124-11612
	22A. S/N A311XXXX & Later Use	2	70135-11612		
	23. Cylinder (1 <sup>st</sup> )	2	70125-51010		
	23A. S/N A311xxxx & Later Use	2	70135-51011		
	24. Cylinder & Case Gasket	2	70135-51610		
	25. Compression Ring (1 <sup>st</sup> )	4	70125-61030		
	26. Oil Control Ring (1 <sup>st</sup> )	4	70125-61050		
	27. Piston (1 <sup>st</sup> )	2	70135-61010-1		
	27A. S/N 3020000 & Later Use	2	70135-61010-1		
	28. Piston Snap Ring	4	70125-61070	2	70125-61070
	29. Piston Pin (1 <sup>st</sup> )	2	70125-61120		
	30. Connecting Rod Piston Pin Bushing (1 <sup>st</sup> )	2	70125-61081	1	70175-62080
	30D. Needle Bearing (2 <sup>nd</sup> ) S/N A409XXXX & Later Use			1	93503-NK28/30
	31. Connecting Rod Assembly, 1 <sup>st</sup> Stage	2	70125-61200	1	70175-61200
	31C. Connecting Rod Assembly, 2 <sup>nd</sup> Stage			1	70175-62201
	32. Connecting Rod Crank Pin Metal	4	70125-61090	2	70125-61090
	33. Connecting Rod Bolt	4	70125-61250	2	70125-61250
	34. Oil Splash Dipper	2	70135-61281	1	70135-61281
	35. Oil Splash Dipper Bolt	2	92501-130800	1	92501-130800
	36. Cylinder Head (2 <sup>nd</sup> )			1	70175-12010
	37. Cylinder (2 <sup>nd</sup> )			1	70175-52010
	38. Compression Ring (2 <sup>nd</sup> )			3	70124-61030
	39. Oil Control Ring (2 <sup>nd</sup> )			2	70124-61050
	40. Piston (2 <sup>nd</sup> )			1	70175-62010-1
	40A. Piston (2 <sup>nd</sup> ), S/N A409XXXX & Later Use			1	70175-62011-1
	41. Piston Pin (2 <sup>nd</sup> )			1	70175-62120
	41A. Piston Pin (2 <sup>nd</sup> ), S/N A409XXXX & Later Use			1	70175-62121
	CRANKCASE AND CRANK ASSEMBLY	42. Crankshaft	1	70135-56011	
43. Crankshaft Counterweight		1	70135-56030		
44. Counterweight Lock Washer		2	70124-56830		
45. Counterweight Mounting Bolt		2	70135-56811		
46. Crankcase		1	70135-57010-4024		
47. Front Bearing Cover		1	70135-57030		
48. Front Bearing Cover Gasket		1	70135-57950		
49. Rear Bearing Cover		1	70134-57061		
49A. Rear Bearing Cover, S/N 3020000 & Later Use		1	70134-57061		
50. Rear Bearing Cover Gasket		1	70134-57960		
51. Front Bearing		1	93502-30310		
52. Rear Bearing		1	93502-32210		
53. Front Oil Seal		1	70134-57080		
54. V-Pulley Pin		1	70134-56060		
55A. Compressor Fan		1	70135-76310		
55B. Compressor Pulley		1	70135-76011		
56. Compressor Pulley Washer		1	70135-76210		
57. Compressor Pulley Set Bolt		1	91501-1312050		
58. Gauge Cover		1	70124-57700		
59. Gauge Cover Seal		1	70124-57730		
60. Crankcase Oil Cap		1	CCC1257		
61. Crankcase Oil Plug		1	90112-100404		
62. Breather Assembly		1	70124-57600-4010		
66A. Air Strainer Assembly		2	70123-66000		
67. Air Strainer Filter		2	70123-66140		
69. Outlet Pipe Joint B		1	70175-87021		
70A. Compressor Body Discharge Piping Assembly, 1 <sup>st</sup>		1	70135-87100(long)		
70B. Compressor Body Discharge Piping Assembly, 1 <sup>st</sup>		1	70135-87200(short)		
70C. Compressor Body Discharge Piping Assembly, 2 <sup>nd</sup>		1	70175-87400(short)		
70D. Compressor Body Discharge Piping Assembly, 2 <sup>nd</sup>		1	70175-87300(long)		
71. Outlet Pipe Joint A		1	70175-87010		
72. Outlet Pipe Joint D		1	70125-87020		
73. Outlet Pipe Joint C		1	70175-87030-4010		
74. Gasket Manifold		4	70125-87510		