

AIR COOLED SINGLE STAGE MODELS ES-30A, ES-50A, ES-100A

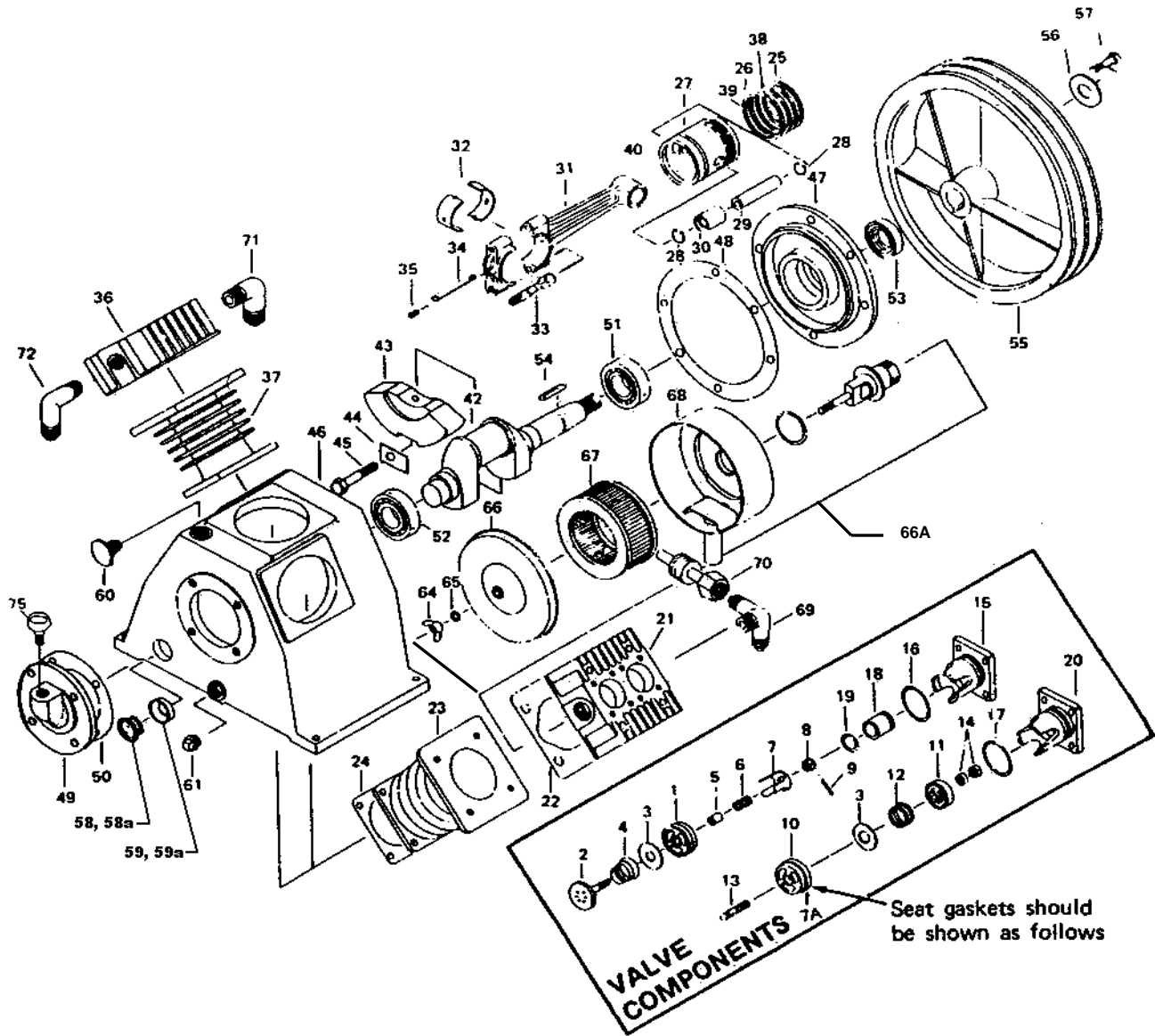

VALVE ASSEMBLIES	Description	Qty. Req.	MODEL ES30A	Qty. Req.	MODEL ES50A	Qty. Req.	MODEL ES100A
	Inlet Valve Assembly, 1 st Stage	2	701208A1-31000	3	701208A1-31000	3	701210A1-31000
Outlet Valve Assembly, 1 st Stage	2	701208A1-41000	3	701208A1-41000	3	701210A1-41000	
Breather Assembly	1	701105A1-57600	1	701105A1-57600	1	701210A1-57601	

MAIN PARTS LISTING FOR MODELS ES-30A, ES-50A, ES-100A

VALVE & UNLOADERS	Item No.	Description	Qty. Req.	MODEL ES30A	Qty. Req.	MODEL ES50A	Qty. Req.	MODEL ES100A
	1.	Inlet Valve Seat	2	701208A1-31010	3	701208A1-31010	3	701210A1-31010
2.	Inlet Valve Receiver	2	701208A1-31020	3	701208A1-31020	3	701210A1-31020	
3.	Inlet & Outlet Valve Plate	2	701208A1-31030	6	701208A1-31030	6	501210A1-31030	
4.	Inlet Valve Spring	2	701208A1-31070	3	701208A1-31070	3	701210A1-31070	
5.	Inlet Valve Unloading Fork Guide	2	701208A1-31090	3	701208A1-31090	3	701210A1-31090	
6.	Unloading Spring	2	701208A1-11230	3	701208A1-11230	3	701210A1-11230	
7A.	Valve Gasket	4	701208A1-11110	6	701208A1-11110	6	701210A1-11110	

**MAIN PARTS LISTING FOR MODELS
ES-30A, ES-50A & ES-100A (Continued)**

		Qty. Req.	MODEL ES30A	Qty. Req.	MODEL ES50A	Qty. Req.	MODEL ES100A			
VALVES & UNLOADERS (Cont'd)	7B		Inlet Valve Unloading Fork	2	701208A1-31080	3	701208A1-31080	3	70210A1-31080	
	8.		Locknut	2	9251313-150800-532	3	9251313-150800-532	3	9251313-151000-532	
	10.		Outlet Valve Seat	2	701208A1-41011	3	701208A1-41011	3	701210A1-41011	
	11.		Outlet Valve Receiver	2	701208A1-41020	3	701208A1-41020	3	701210A1-41020	
	12.		Outlet Valve Spring	2	701208A1-41070	3	701208A1-41070	3	701210A1-41070	
	13.		Outlet Valve Bolt	2	701208A1-41810	3	701208A1-41810	3	9152613-1110050-5608	
	14.		Nut (Outlet Valve)	4	9250113-150800-532	6	9250113-150800-532	6	9250113-121000-532	
	15.		Inlet Valve Push Cover, 1 st Stage	2	701208A1-11150	3	701208A1-11150	3	701210A1-11150	
	16.		O – Ring G 40 (G55 ES100)	2	9360281-310394	3	9360281-310394	3	9360281-310544	
	17.		Viton O – Ring G 40 (Outlet Valve)	2	9360287-310394	3	9360287-310394	3	9360287-310544	
	18.		Unloading Piston, 1 st Stage	2	701208A1-11220	3	701208A1-11220	3	701210A1-11220	
	19.		O – Ring P 20 (P21 ES100)	2	9360181-240198	3	9360181-240198	3	9360187-240208	
	20.		Outlet Valve Push Cover, 1 st Stage	2	701208A1-11450	3	701208A1-11450	3	701210A1-11450	
	CYLINDERS	21A.		Cylinder Head Assembly	2	70123-41000	3	70123-41000		-
		21.		Cylinder Head (1 st)	2	701208A2-11010	3	701208A2-11010	3	701210A2-11010
		22.		Cylinder & Head Gasket, 1 st Stage	2	701208A1-11020	3	701208A1-11020	3	701210A1-11020
		23.		Cylinder (1 st)	2	701208A2-51010	3	701208A2-51010	3	701210A2-51010
		23A.		S/N 3020000 THRU A311XXXX	2	701208A1-51010	3	701208A2-51010	3	701210A2-51010
		24.		Cylinder & Case Gasket	2	701208A1-51030	3	701208A1-51030	3	701210A1-51030
		25.		Compression Ring (1 st)	4	701208A1-61030	6	701208A1-61030	6	701210A1-61030
26.			Oil Control Ring (1 st)	4	701208A1-61050	6	701208A1-61050	6	701210A1-61050	
27.			Piston (1 st)	2	701208A1-61012	3	701208A1-61012	3	701210A1-61011	
27A.			S/N 3020000 & later use	2	70123-61011	3	70123-61011	3	701210A1-61011	
28.			Piston Pin Snap Ring	4	701208A1-61070	6	701208A1-61070	6	701210A1-61070	
29.			Piston Pin (1 st)	2	701208A1-61120	3	701208A1-61120	6	701210A1-61120	
30.			Connecting Rod Piston Pin Bushing (1 st)	2	70123-61081	3	70123-61081	3	70124-61080	
31.			Connecting Rod Assembly, 1 st Stage	2	701208A1-61201	3	701208A1-61201	3	701210A1-61201	
31A.			S/N 3020000 & later use	2	701208A1-61201	3	701208A1-61201	3	701210A1-61201	
32.			Connecting Rod Crank Pin Metal	4	70123-61090	6	70123-61090	6	70124-61090	
33.			Connecting Rod Bolt	4	70123-61250	6	70123-61250	6	70125-61250	
33A.			Oil Splash Dipper H.P.		-	1	70130FA1-61290	1	701310A1-61290	
34.			Oil Splash Dipper	2	70120FA1-61282	2	70120FA1-61282	2	701310A1-61281	
35.			Oil Splash Dipper Bolt	2	9151313-1104012-5602	3	9151313-1104012-5602	3	9151313-1105016-5602	
CRANKCASE & CRANK ASSEMBLY		42.		Crankshaft	1	701208A1-56011	1	701308A1-56011	1	701310A1-56010
		43.		Counterweight		-		-	2	701310A1-56030
		44.		Lockwasher		-		-	2	701210A1-56830
		45.		Bolt		-		-	2	701210A1-56810
		46.		Crankcase	1	701208A2-57010	1	701308A2-57010	1	701310A2-57010
		47.		Front Bearing Cover	1	701208A1-57030	1	701308A1-57030	1	701310A1-57031
		48.		Front Bearing Cover Gasket	1	701208A1-57040	1	701208A1-57040	1	701210A1-57040
		49.		Rear Bearing Cover	1	701208A1-57061	1	701308A1-57061	1	701310A1-57061
		49A.		S/N 3020000 & later use	1	701208A1-57061	1	701308A1-57061	1	701310A1-57061
		50.		Rear Bearing Cover Gasket	1	701208A1-57070	1	701308A1-57070	1	701310A1-57070
		51.		Front Bearing	1	9350104-6206	1	9360112-6306	1	9354501-32210
		52.		Rear Bearing	1	9350104-6206	1	9360112-6306	1	9354501-32210
		53.		Front Oil Seal	1	701208A1-57080	1	701208A1-57080	1	701310A1-57080
		54.		V – Pulley Pin	1	701208A1-56061	1	701208A1-56061	1	701310A1-56060
		55A.		Compressor Fan	1	(Not Required)	1	(Not Required)	1	70121071-76311
	55B.		Compressor Pulley	1	701208A1-76010	1	701308A1-76010	1	701310A1-76011	
	56.		Compressor Pulley Washer	1	701208A1-76210	1	70124-76210	1	701210A1-76210	
	57.		Compressor Pulley Set Bolt	1	9150113-1112030-5608	1	9150113-1112030-5608	1	9150113-1112040-5608	
	58.		Gauge Cover	1	70141-57700	1	70141-57700	1	701210A1-57740	
	58 *A.		Oil Level Gauge Assy.	1	70A109B1-57701	1	70A109B1-57701	1	701210A1-57700	
	59.		Gauge Cover Seal	1	70141-57730	1	70141-57730	1	701210A1-57730	
	59 *A.		Oil Level Gauge "O" Ring	1	9360281-260265	1	9360281-260265		-	
	60.		Crankcase Oil Cap	1	CCC1257	1	CCC1257	1	CCC1257	
	61.		Crankcase Oil Plug	1	9156310-400800	1	9156310-400800	1	9156310-400800	
	66A.		Air Strainer Assembly	2	701208A1-66000	3	701208A1-66000	3	701312A1-66000	
	67.		Air Strainer Filter	2	701208A1-66140	3	701208A-66110	3	701208A1-66110	
	69.		Outlet Pipe Joint B	1	70123-87020	1	70133-87020	1	70134-87020	
	70.		Compressor Body Discharge Piping Assy.	1	70123-87100	2	701308A1-87101	2	70134-87100	
	70A.		S/N 3020000 & Later Use	1	701208A1-87101	2	701308A1-87101	2	701310A1-87101	
	71.		Outlet Pipe Joint A	1	701208A1-87011	1	70123-87010	1	70124-87010	
73.		Outlet Pipe Joint C		-	1	70133-87030	1	70134-87030		
74.		Gasket (Manifold)		-		-		-		
75.		Breather Assembly	1	CCC1375	1	CCC1375	1	CCC1375		

* ES30, START S/N AS4030091

* ES50, START S/N AS4030115